



PEPPERL+FUCHS

Proximity Switch Brackets

Easy Installation For Standard Rectangular Proxes



Rectangular DIN proximity switches are extremely rugged and have very long ranges, but mounting and adjusting can be very difficult compared to barrel proxies.

Pepperl+Fuchs have bracket solutions that allow you to not only fit your prox easily, but also allows you to adjust the position on two axes very quickly without having to re-drill new mounting holes or fabricate new brackets.

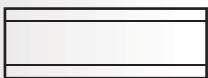

Step One:

Install a length of C-Rail or Unistrut

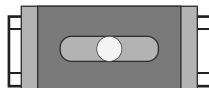

Step Two:

Connect the Matching MH 4 Bracket



Step Three:

Attach Your Proximity Switch Loosely

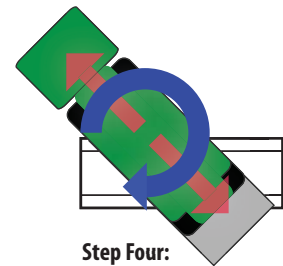

Step Four:

Adjust Position and Rotation of Sensor and Tighten

Make Your Installation Easier - Contact Us



Illawarra
Industrial
Instrumentation

02 4222 1555

<http://www.iii.net.au>